

450FP Installation Order

■ Check list

- Please check the door open direction & thickness at first.
- If the door thickness is more than 45mm to Max 70mm, It is possible to install after applying Option parts for it.
 - Option : 1) Body Guide pin : 4EA Front Body's Guide Pin : 4EA
 - 2) Key set : 1EA

■ Installation Order

- 1) Please mark the hole location with using installation guide paper on the door. According to the door open direction, please use this installation paper as back & fore side.

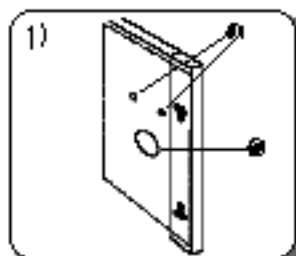

Please make a hole in location of No.1, No.2

- 2) After make the holes on the No.1, No.2 at the inside door, Please make a hole on the No.3 at the outside door.

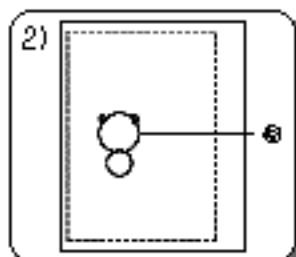

- 3) After input rubber plate at the external body of VIRDI 450FP, The external body makes correct location on the door with matching hole location. And then, Please pull out the main cable & sensor cable

from inside door through No2.'s hole location.

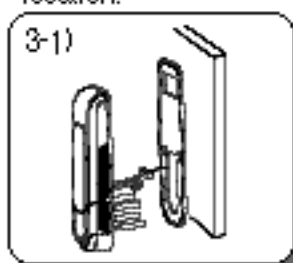

Notice) Before install the Lock body of VIRDI 450FP at the inside door, Please check the door's direction such as Left-Hand Use, Right-Hand Use.

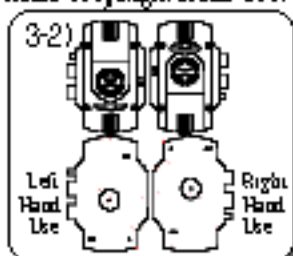

- 4) After install the plate with 4pcs of screws (T/H 8x20mm, 1), please install the external plate with 4pcs of screw (M/S 5x20mm 2). And then connect main cable & sensor cable.

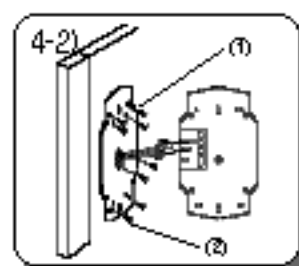
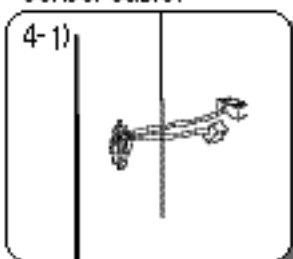

- 5) Please connect the Lock body at the door with 4pcs of screws (M/S 5 x 34mm) as following picture.

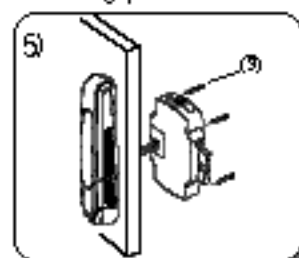

- 6) Please connect a female lock bracket at the doorframe with 4pcs of screw (T/H 8x20mm)

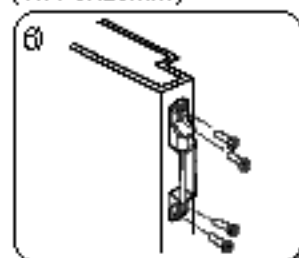

■ After installation

1. Please check the door's open/close status.
2. Please insert Batteries
3. Please use VIRDI 450FP with User manual for fingerprint registration & PW/ setup.